

SIRUBA®

銀爺牌工業用縫紉機

INDUSTRIAL SEWING MACHINE

T828

零件圖 PARTS LIST



From the library of: Diamond Needle Corp

CE



高林股份有限公司
KAULIN MFG. CO., LTD.

									
MODEL	OPERATING PANEL	SUB-CLASS	NEEDLE PLATE	FEED DOG	NEEDLE CLAMP	PRESSER FOOT	HOOK	BOBBIN	NEEDLE
機 型	操作盒	規 格	針 板	下送具	針 釗	押 具	旋 梭	梭 子	針 號
T828-42-032ML		1/8"(3.2)	E734	D734/P	M734	P734/S	G161	G307	DPX5#14
T828-42-048ML		3/16"(4.8)	E736	D736/P	M736	P736/S	G161	G307	DPX5#14
T828-42-064ML		1/4"(6.4)	E730	D730/P	M730	P730/S	G161	G307	DPX5#14
T828-42-032M		1/8"(3.2)	E734	D734/P	M734	P734/S	G162-A (G162+G406)	G307	DPX5#14
T828-42-048M		3/16"(4.8)	E736	D736/P	M736	P736/S	G162-A (G162+G406)	G307	DPX5#14
T828-42-064M		1/4"(6.4)	E730	D730/P	M730	P730/S	G162-A (G162+G406)	G307	DPX5#14
T828-42-032HL		1/8"(3.2)	E762	D734/P	M734	P734/S	G167	G307	DPX5#22
T828-42-048HL		3/16"(4.8)	E761	D736Q	M736	P736/S	G167	G307	DPX5#22
T828-42-064HL		1/4"(6.4)	E760	D730Q	M730	P730/S	G167	G307	DPX5#22
T828-42-032H		1/8"(3.2)	E762	D734/P	M734	P734/S	G162-A (G162+G406)	G307	DPX5#22
T828-42-048H		3/16"(4.8)	E761	D736Q	M736	P736/S	G162-A (G162+G406)	G307	DPX5#22
T828-42-064H		1/4"(6.4)	E760	D730Q	M730	P730/S	G162-A (G162+G406)	G307	DPX5#22
T828-42-032ML/C	C300M-A2	1/8"(3.2)	E754-A	D754	M734	P754/S	G163	G307	DPX5#14
T828-42-048ML/C	C300M-A2	3/16"(4.8)	E766-A	D766	M736	P766/S	G163	G307	DPX5#14
T828-42-064ML/C	C300M-A2	1/4"(6.4)	E745-A	D745	M730	P745/S	G163	G307	DPX5#14
T828-42-032M/C	C300M-A2	1/8"(3.2)	E754-A	D754	M734	P754/S	G164-A (G164+G406)	G307	DPX5#14
T828-42-048M/C	C300M-A2	3/16"(4.8)	E766-A	D766	M736	P766/S	G164-A (G164+G406)	G307	DPX5#14
T828-42-064M/C	C300M-A2	1/4"(6.4)	E745-A	D745	M730	P745/S	G164-A (G164+G406)	G307	DPX5#14







規格件表 CONVERSION CHART-2

MODEL 機 型	OPERATING PANEL 操作盒	SUB-CLASS 規 格	NEEDLE PLATE 針 板	FEED DOG 下送具	NEEDLE CLAMP 針 釧	PRESSER FOOT 押 具	HOOK 旋 梭	BOBBIN 梭 子	NEEDLE 針 號
T828-42-032HL/C	C300M-A2	1/8"(3.2)	E788-A	D788	M734	P754/S	G163	G307	DPX5#22
T828-42-048HL/C	C300M-A2	3/16"(4.8)	E787-A	D787	M736	P766/S	G163	G307	DPX5#22
T828-42-064HL/C	C300M-A2	1/4"(6.4)	E786-A	D786	M730	P745/S	G163	G307	DPX5#22
T828-42-032H/C	C300M-A2	1/8"(3.2)	E788-A	D788	M734	P754/S	G164-A (G164+G406)	G307	DPX5#22
T828-42-048H/C	C300M-A2	3/16"(4.8)	E787-A	D787	M736	P766/S	G164-A (G164+G406)	G307	DPX5#22
T828-42-064H/C	C300M-A2	1/4"(6.4)	E786-A	D786	M730	P745/S	G164-A (G164+G406)	G307	DPX5#22
T828-42-040VL/C	C300M-A2	5/32"(4.0)	E755P-A	D755P	M735P-E	P775P	G163	G307	DPX5#14
T828-42-048VL/C	C300M-A2	3/16"(4.8)	E766P-A	D766P	M766P-E	P766P	G163	G307	DPX5#14
T828-42-127KL/C	C301-A	1/2"(12.7)	E763-A	D763	M763	P763	G163	G307	DPX5#14
T828-45-032M		1/8"(3.2)	E762	D734/P	M0032R M0032L	P734/S	G169-A (G169+G409)	G307	DPX5#14
T828-45-048M		3/16"(4.8)	E761	D736/P	M0048R M0048L	P736/S	G169-A (G169+G409)	G307	DPX5#14
T828-45-064M		1/4"(6.4)	E760	D730/P	M0064R M0064L	P730/S	G169-A (G169+G409)	G307	DPX5#14
T828-45-032H		1/8"(3.2)	E762	D734/P	M0032R M0032L	P734/S	G169-A (G169+G409)	G307	DPX5#22
T828-45-048H		3/16"(4.8)	E761	D736Q	M0048R M0048L	P736/S	G169-A (G169+G409)	G307	DPX5#22
T828-45-064H		1/4"(6.4)	E760	D730Q	M0064R M0064L	P730/S	G169-A (G169+G409)	G307	DPX5#22
T828-45-032M/C	C300M-A2	1/8"(3.2)	E788-A	D754	M0032R M0032L	P754/S	G170-A (G170+G410)	G307	DPX5#14
T828-45-048M/C	C300M-A2	3/16"(4.8)	E787-A	D766	M0048R M0048L	P766/S	G170-A (G170+G410)	G307	DPX5#14
T828-45-064M/C	C300M-A2	1/4"(6.4)	E786-A	D745	M0064R M0064L	P745/S	G170-A (G170+G410)	G307	DPX5#14

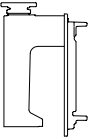
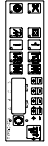
									
MODEL	OPERATING PANEL	SUB-CLASS	NEEDLE PLATE	FEED DOG	NEEDLE CLAMP	PRESSER FOOT	HOOK	BOBBIN	NEEDLE
機 型	操作盒	規 格	針 板	下送具	針 釧	押 具	旋 梭	梭 子	針 號
T828-45-032H/C	C300M-A2	1/8 [*] (3.2)	E788-A	D788	M0032R M0032L	P754/S	G170-A (G170+G410)	G307	DPX5#22
T828-45-048H/C	C300M-A2	3/16 [*] (4.8)	E787-A	D787	M0048R M0048L	P766/S	G170-A (G170+G410)	G307	DPX5#22
T828-45-064H/C	C300M-A2	1/4 [*] (6.4)	E786-A	D786	M0064R M0064L	P745/S	G170-A (G170+G410)	G307	DPX5#22
T828-47-032LL		1/8 [*] (3.2)	E791	D791	M734	P791/S	G161	G307	DPX5#11
T828-47-048LL		3/16 [*] (4.8)	E790	D790	M736	P790/S	G161	G307	DPX5#11
T828-47-064LL		1/4 [*] (6.4)	E789	D789	M730	P789/S	G161	G307	DPX5#11
T828-47-032L		1/8 [*] (3.2)	E791	D791	M734	P791/S	G162-A (G162+G406)	G307	DPX5#11
T828-47-048L		3/16 [*] (4.8)	E790	D790	M736	P790/S	G162-A (G162+G406)	G307	DPX5#11
T828-47-064L		1/4 [*] (6.4)	E789	D789	M730	P789/S	G162-A (G162+G406)	G307	DPX5#11
T828-47-032LL/C	C300M-A2	1/8 [*] (3.2)	E794-A	D794	M734	P791A	G163	G307	DPX5#11
T828-47-048LL/C	C300M-A2	3/16 [*] (4.8)	E793-A	D793	M736	P790A	G163	G307	DPX5#11
T828-47-064LL/C	C300M-A2	1/4 [*] (6.4)	E792-A	D792	M730	P789A	G163	G307	DPX5#11
T828-47-032L/C	C300M-A2	1/8 [*] (3.2)	E794-A	D794	M734	P791A	G164-A (G164+G406)	G307	DPX5#11
T828-47-048L/C	C300M-A2	3/16 [*] (4.8)	E793-A	D793	M736	P790A	G164-A (G164+G406)	G307	DPX5#11
T828-47-064L/C	C300M-A2	1/4 [*] (6.4)	E792-A	D792	M730	P789A	G164-A (G164+G406)	G307	DPX5#11
T828-48-032L		1/8 [*] (3.2)	E791	D791	M0032R M0032L	P791/S	G169-A (G169+G409)	G307	DPX5#11
T828-48-048L		3/16 [*] (4.8)	E790	D790	M0048R M0048L	P790/S	G169-A (G169+G409)	G307	DPX5#11
T828-48-064L		1/4 [*] (6.4)	E789	D789	M0064R M0064L	P789/S	G169-A (G169+G409)	G307	DPX5#11

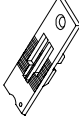
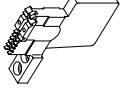
規格件表 CONVERSION CHART-4

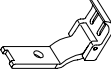
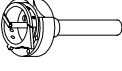
機 型	OPERATING PANEL 操作盒	SUB-CLASS 規 格	NEEDLE PLATE 針 板	FEED DOG 下送具	NEEDLE CLAMP 針 釧	PRESSER FOOT 押 具	HOOK 旋 梭	BOBBIN 梭 子	NEEDLE 針 號
T828-48-032L/C	C300M-A2	1/8"(3.2)	E794-A	D794	M0032R M0032L	P791A	G170-A (G170+G410)	G307	DPX5#11
T828-48-048L/C	C300M-A2	3/16"(4.8)	E793-A	D793	M0048R M0048L	P790A	G170-A (G170+G410)	G307	DPX5#11
T828-48-064L/C	C300M-A2	1/4"(6.4)	E792-A	D792	M0064R M0064L	P789A	G170-A (G170+G410)	G307	DPX5#11
T828-72-032ML		1/8"(3.2)	E762	D734/P	M734	P762/S	G165	G310	DPX5#14
T828-72-048ML		3/16"(4.8)	E761	D736/P	M736	P761/S	G165	G310	DPX5#14
T828-72-064ML		1/4"(6.4)	E760	D730/P	M730	P760/S	G165	G310	DPX5#14
T828-72-032HL		1/8"(3.2)	E762	D734/P	M734	P762/S	G165	G310	DPX5#22
T828-72-048HL		3/16"(4.8)	E761	D736Q	M736	P761/S	G165	G310	DPX5#22
T828-72-064HL		1/4"(6.4)	E760	D730Q	M730	P760/S	G165	G310	DPX5#22
T828-72-032M/C	C300M-A2	1/8"(3.2)	E788-A	D754	M734	P762/S	G168-A (G168+G411)	G310	DPX5#14
T828-72-048M/C	C300M-A2	3/16"(4.8)	E787-A	D766	M736	P761/S	G168-A (G168+G411)	G310	DPX5#14
T828-72-064M/C	C300M-A2	1/4"(6.4)	E786-A	D745	M730	P760/S	G168-A (G168+G411)	G310	DPX5#14
T828-72-032H/C	C300M-A2	1/8"(3.2)	E788-A	D788	M734	P762/S	G168-A (G168+G411)	G310	DPX5#22
T828-72-048H/C	C300M-A2	3/16"(4.8)	E787-A	D787	M736	P761/S	G168-A (G168+G411)	G310	DPX5#22
T828-72-064H/C	C300M-A2	1/4"(6.4)	E786-A	D786	M730	P760/S	G168-A (G168+G411)	G310	DPX5#22
T828-75-032M		1/8"(3.2)	E762	D734/P	M0032R M0032L	P762/S	G166-A (G166+G407)	G310	DPX5#14
T828-75-048M		3/16"(4.8)	E761	D736/P	M0048R M0048L	P761/S	G166-A (G166+G407)	G310	DPX5#14
T828-75-064M		1/4"(6.4)	E760	D730/P	M0064R M0064L	P760/S	G166-A (G166+G407)	G310	DPX5#14

									
MODEL	OPERATING PANEL	SUB-CLASS	NEEDLE PLATE	FEED DOG	NEEDLE CLAMP	PRESSER FOOT	HOOK	BOBBIN	NEEDLE
機 型	操作盒	規 格	針 板	下送具	針 釧	押 具	旋 梭	梭 子	針 號
T828-75-032H		1/8" (3.2)	E762	D734/P	M0032R M0032L	P762/S	G166-A (G166+G407)	G310	DPX5#22
T828-75-048H		3/16" (4.8)	E761	D736Q	M0048R M0048L	P761/S	G166-A (G166+G407)	G310	DPX5#22
T828-75-064H		1/4" (6.4)	E760	D730Q	M0064R M0064L	P760/S	G166-A (G166+G407)	G310	DPX5#22
T828-75-032M/C	C300M-A2	1/8" (3.2)	E788-A	D754	M0032R M0032L	P762/S	G168-A1 (G168+G408)	G310	DPX5#14
T828-75-048M/C	C300M-A2	3/16" (4.8)	E787-A	D766	M0048R M0048L	P761/S	G168-A1 (G168+G408)	G310	DPX5#14
T828-75-064M/C	C300M-A2	1/4" (6.4)	E786-A	D745	M0064R M0064L	P760/S	G168-A1 (G168+G408)	G310	DPX5#14
T828-75-032H/C	C300M-A2	1/8" (3.2)	E788-A	D788	M0032R M0032L	P762/S	G168-A1 (G168+G408)	G310	DPX5#22
T828-75-048H/C	C300M-A2	3/16" (4.8)	E787-A	D787	M0048R M0048L	P761/S	G168-A1 (G168+G408)	G310	DPX5#22
T828-75-064H/C	C300M-A2	1/4" (6.4)	E786-A	D786	M0064R M0064L	P760/S	G168-A1 (G168+G408)	G310	DPX5#22

MODEL	T828-42/45/T828-47/48/T828-72/75			
	M	H	L	H
PARTS NO	TD01	TD01	TD01	TD30
	TD02	TD02	TD02	TD31
	TD03	TD03	TD03	TD03
	TD04	TD04	TD04	TD28
	TD19	TD19	TD19	TD29

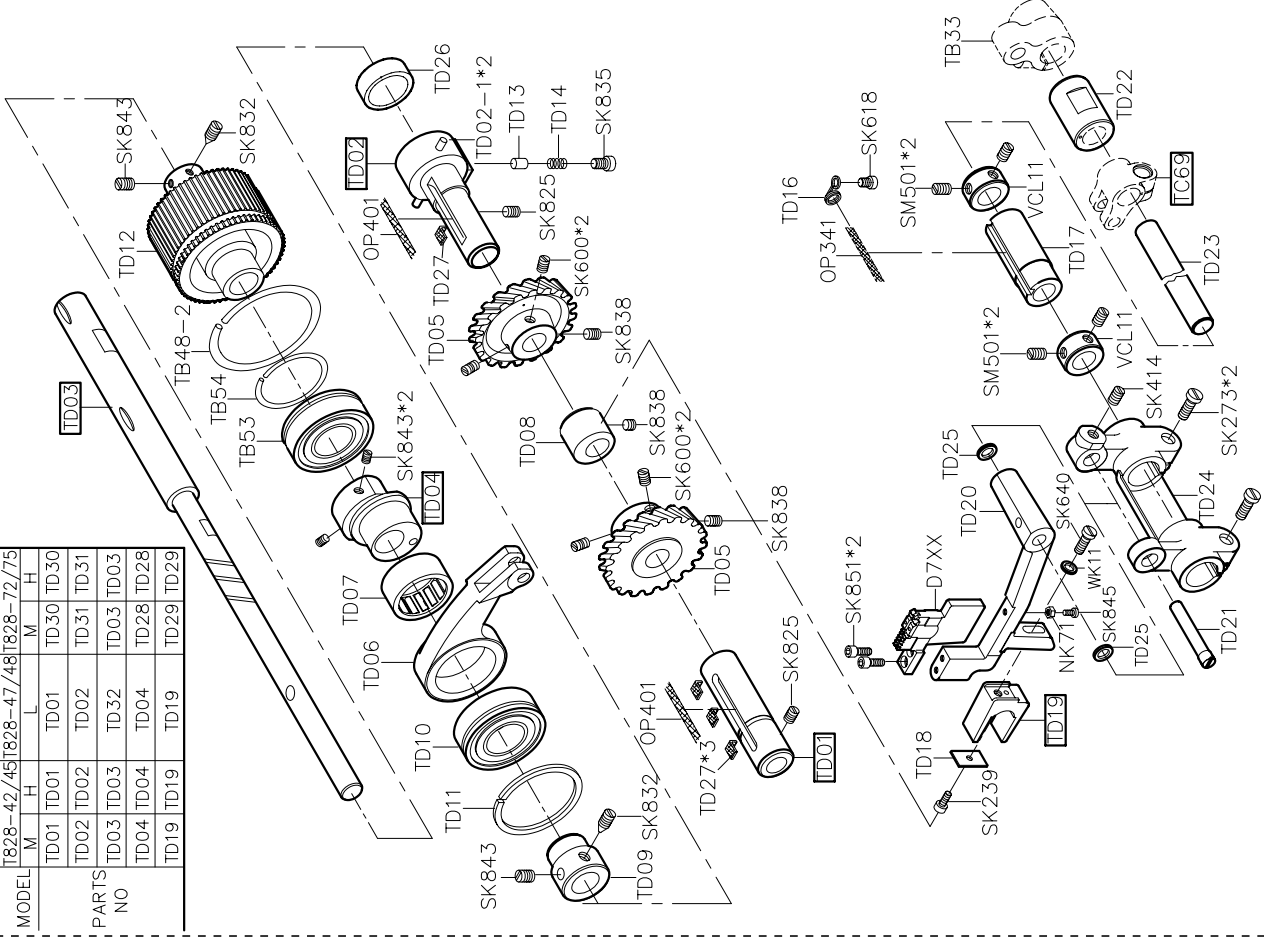

MODEL	T828-42/45/T828-72/75			
	M	H	M	H
PARTS NO	TE06	TE06	TE56	TE56
	TE07	TE07	TE57	TE57
	TE15	TE15	TE58	TE58
	TE18	TE18	TE59	TE59
	TE52	TE52	TE62	TE62
	TE53	TE53	TE63	TE63

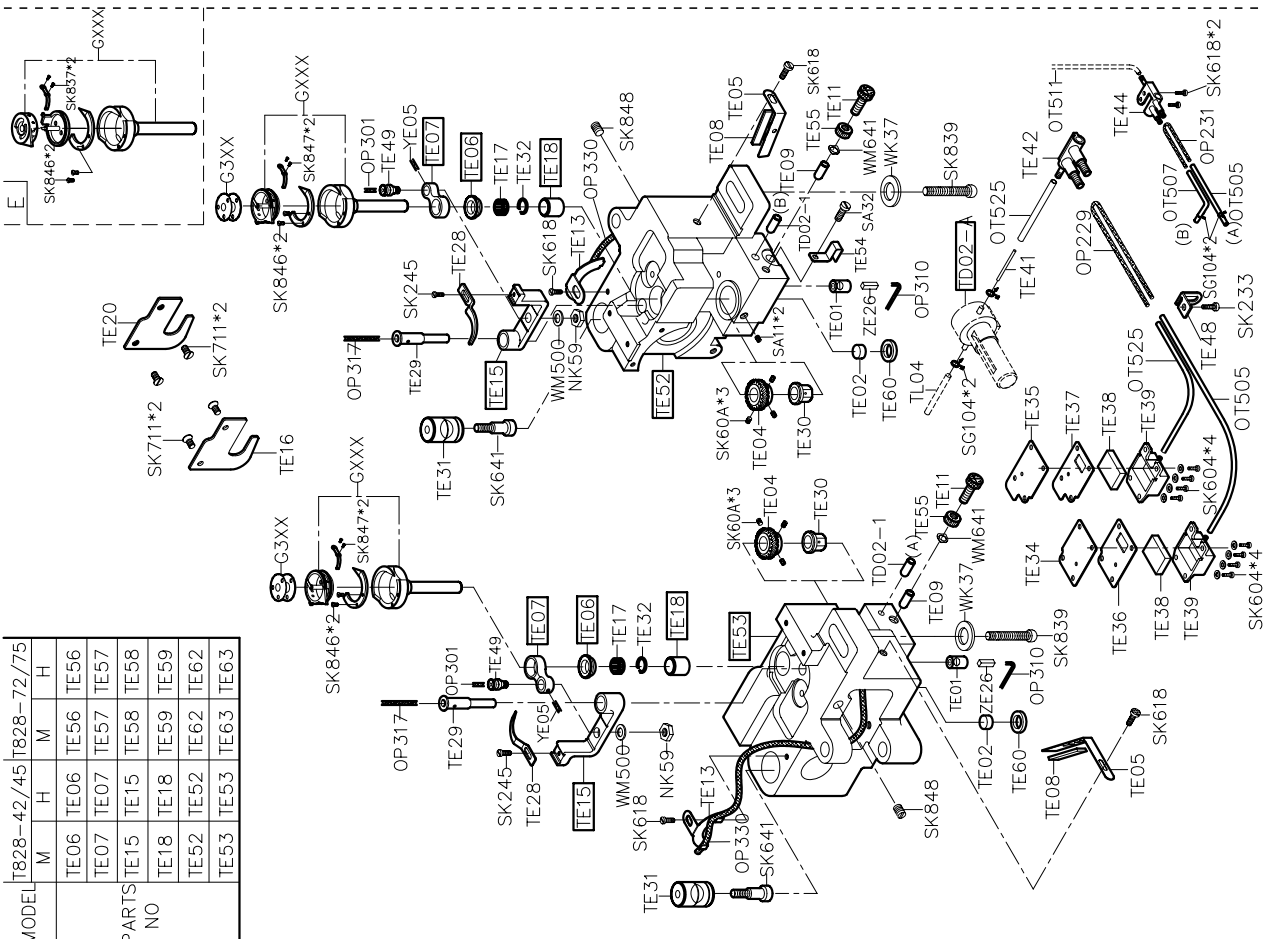

PY11-3

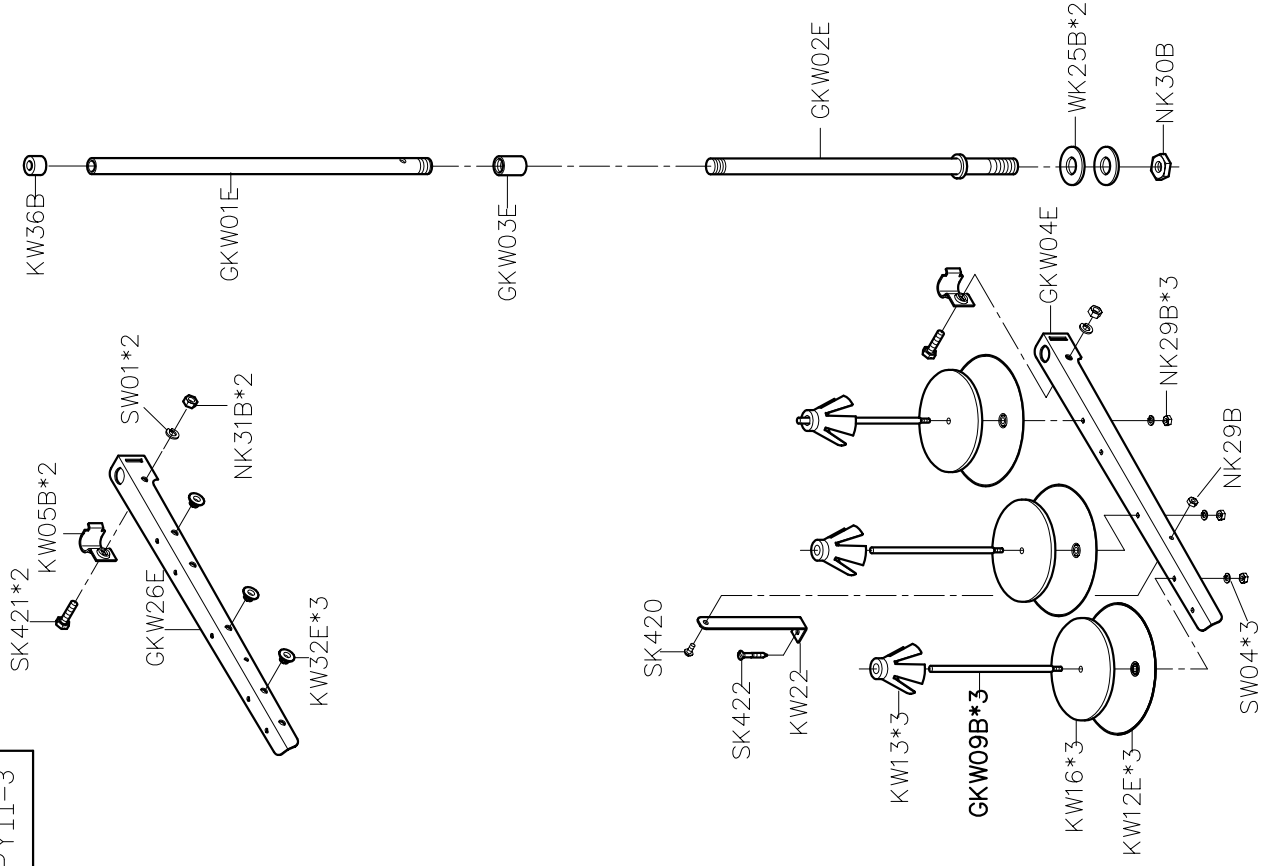

GTY07-A 手輪護蓋

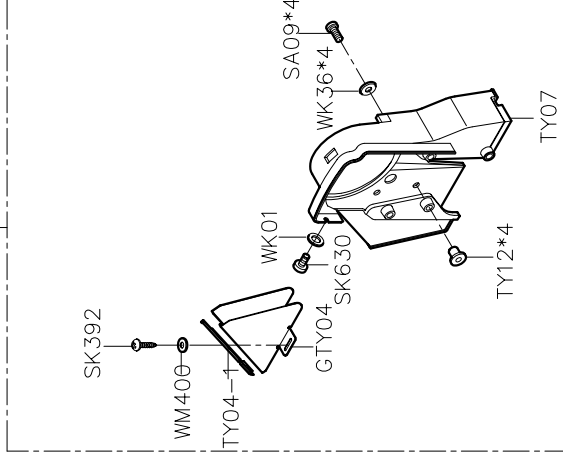

GTY08-A 油盤

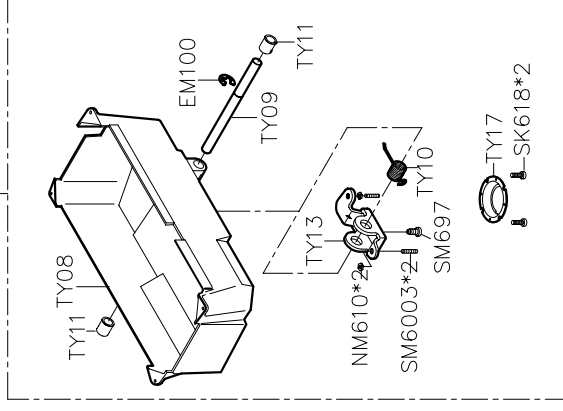



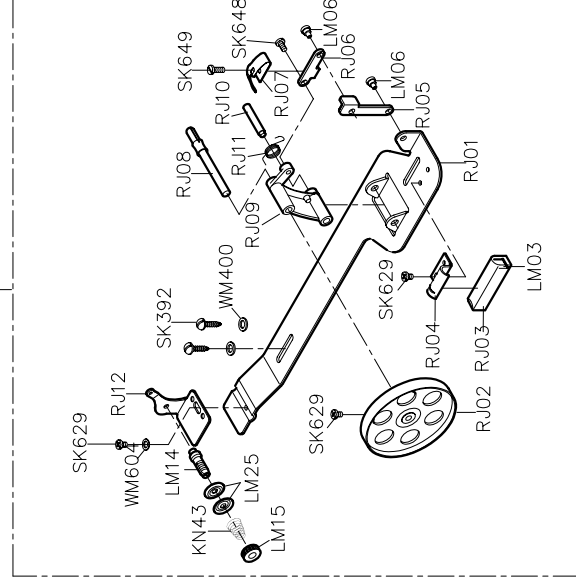



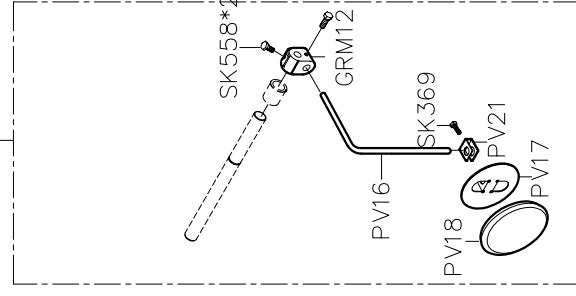



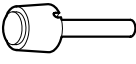

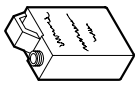



RJ01-A 繞線器

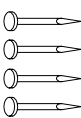
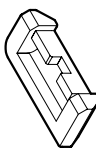

GPV16-A 腳弓

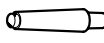

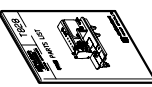
PARTS LIST FOR TY (2) GROUP

01	說明書		14	押具提昇軸		15*4	防震橡膠墊		GXXX*4	梭子		KY02-A	油罐		KY03	油壺		GMY01	防塵罩																		
MY11	六角板手		MY13	六角板手		KY10	六角板手		PY05*4	鐵釘		LY04*2	後鈕墊		KY09	開口板手		KZ03	乾燥劑		KY17	一字起子		LY02	木頭桿		GKY26F	工具袋		針*4		TY02	零件圖		☆TP156	使用說明書	

FOR T828 ☆TP 開袋機用

MODEL	T828-42		T828-45		T828-47		T828-48		T828-72		T828-75	
	M	H	M	H	L	L	L	L	M	H	M	H
PARTS NO	G307	G307	G307	G307	G307	G307	G307	G310	G310	G310	G310	G310
	KY17	KY14	KY14	KY14	KY17	KY14	KY14	KY17	KY17	KY14	KY14	KY14
	DPX5#14	DPX5#22	DPX5#4	DPX5#22	DPX5#11	DPX5#11	DPX5#11	DPX5#14	DPX5#22	DPX5#14	DPX5#14	DPX5#22



T828

高林股份有限公司 KAULIN MFG. CO., LTD.

From the library of: Diamond Needle Corp